

Overview

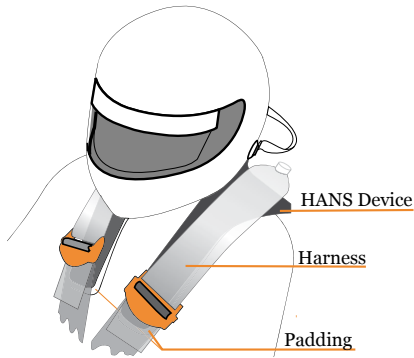

- HANS Device is worn under the harness
- Change or remove padding for best fit
- Never modify the body of the HANS Device

Clearance

- HANS Device should not contact helmet or headrest
- About 1.5" (40mm) clearance is required

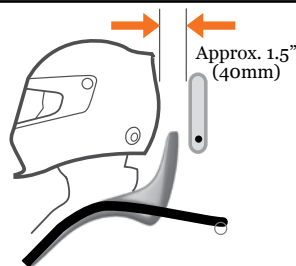

Tethers

Fixed Tethers

- Factory preset 6" (150mm) fits most situations
- Adjust +/- 1" (25mm) if desired

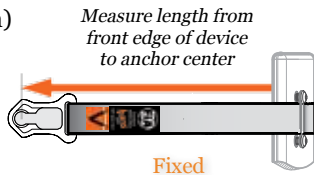

Sliding Tethers

- Standard length fits most situations
- Not adjustable
- Do not over tighten tether carriers

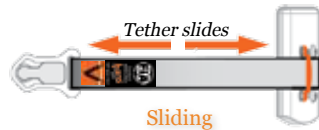

Helmet Anchors - Post Anchor™

- Align slot in catch with slots on post, push in and slide catch rearward
- Push in and slide catch forward to remove



Helmet Anchors - LW2™ Anchor

- Tether is permanently sewn to LW2 anchor
- Anchor is permanently attached to helmet



Helmet Anchors - QuickClick™ Anchor

- Open anchor by pulling red release tether, slip tether loop over hasp and close
- To release pull red release tether and remove tether loop from hasp



Belt Mounting

- 1-2" (25-50mm) below horizontal
- Minimize this distance - *do not exceed 8" (200mm)*
- 3" (75mm) maximum belt separation
- Belts should wrap up HANS Device collar as shown

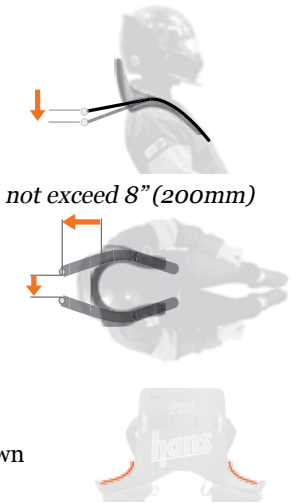

Sliding Tether Upgrade Kit Instructions



Helmet Anchors

Remove existing HANS anchors from helmet
 Discard old nutwasher, save and re-use other parts
 Reinstall HANS anchors with new, larger nutwashers
 Threadlocker must be used on reinstallation

IMPORTANT
 Ensure you use the new, larger nutwasher supplied

New Large Nutwasher is 1.75" (44.5 mm) Diameter

Tether Carriers

Remove existing tether clamps
 Remove, discard old tethers
 Carefully place sliding carriers over sliding tether
 Hand tighten screws - do not over tighten!



#1 FOR VISION



#1 FOR WINNERS



#1 FOR PERFORMANCE

Helmet Anchor Installation

Get ready by assembling these tools: Wrenches, screwdriver, measuring tape, pen, drill, masking tape and threadlocker.

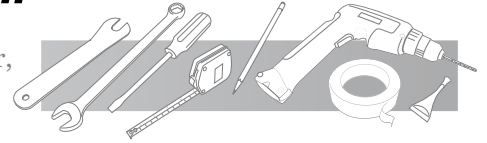

Initial Steps - All Helmet Anchors

1. Apply masking tape to protect your helmet before you start (fig. 1). Using a flexible ruler, measure from a hard point (shield pivot screw) on each side back to the approximate center of the helmet (fig. 2) Draw a line on each side – the actual center line will be between your two measurements (fig. 3).
2. Draw three horizontal lines on the tape 1.5" (40mm) up from the top edge of the rubber molding (figs. 3, 4). Measure 6" (150mm) forward from the rear center line on each side of the helmet. Mark where this measurement intersects the horizontal line – this is where you will install the anchors (fig. 4). Make sure you have two marks, each 6" forward from the rear center line and 1.5" up from the top edge of the helmet's rubber edge molding.
3. Slowly drill a 1/4" (6mm) hole at the two hole centers marked above. Drill through the helmet shell but not through the soft padding. A thin piece of sheet metal can be slipped between the shell and padding to help this (fig. 5). De-burr and clean the holes.

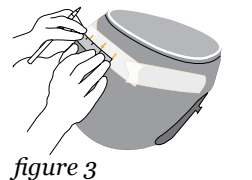
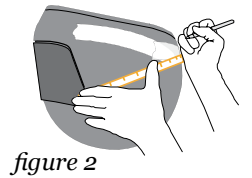
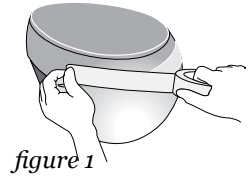

Final Steps - Post Anchors

- A. Gently pry helmet liner away from shell using blunt instrument (fig. 6) and insert the nutwasher inside the helmet against the shell using a wrench. Align with hole. Put a drop of threadlocker sealant on post threads then insert post through cap, spring and base and screw into nutwasher. Take care not to cross thread the assembly. Hand tighten until the point of the post faces rearward and slightly downward. Make sure the assembly matches the exploded view below.
- B. Use a 7/16" (11mm) wrench to hold the post anchor outside of the helmet in position and tighten from inside (fig. 7). Tighten 1/4 turn beyond snug. The flats and slot of the post anchor should be roughly parallel with the ground and the point of the anchor should face toward the rear of the helmet.

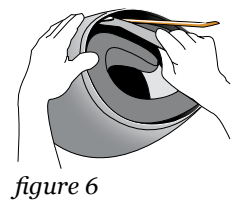
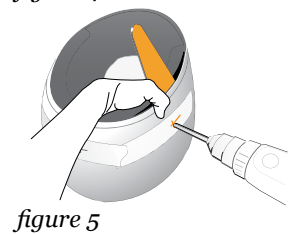
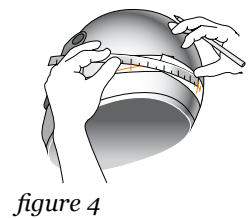

Final Steps - LW2 Anchors

Gently pry helmet liner away from shell using blunt instrument (fig. 6) and insert the nutwasher inside the helmet against the shell using a wrench. Align with hole. Put a drop of threadlocker sealant on Philips screw supplied then screw into nutwasher. Take care not to cross thread the assembly. Hand tighten until the tether faces rearward. Use a 7/16" (11mm) wrench to hold the nutwasher inside the helmet and tighten exterior screw 1/4 turn beyond snug.



Final Steps - QuickClick Anchors

Gently pry helmet liner away from shell using blunt instrument (fig. 6) and insert the nutwasher inside the helmet against the shell using a wrench. Align with hole. Put a drop of threadlocker sealant on Hexhead screw supplied then screw into nutwasher. Take care not to cross thread the assembly. Hand tighten until the anchor hasp faces rearward. Use a 7/16" (11mm) wrench to hold the nutwasher inside the helmet and tighten exterior screw 1/4 turn beyond snug.

Helmet Post Anchor Exploded View

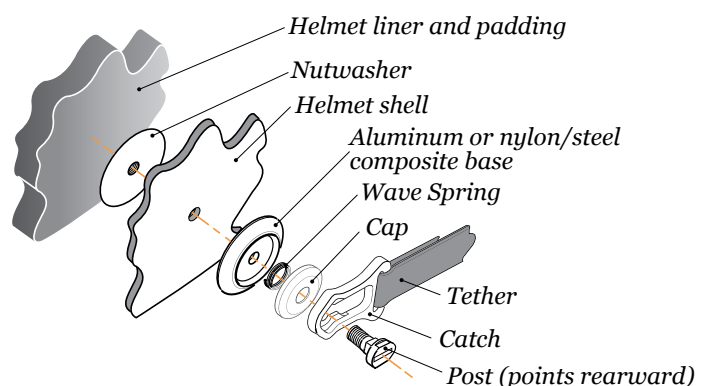

Important Note

Kits are supplied with enough components to fully replace old equipment. If you think your kit is missing pieces contact us immediately.

